



The world's favorite lock

HSA6000 series

Wirefree Yale HSA6010 Door/Window contact

(Yale part number: 666010001001)

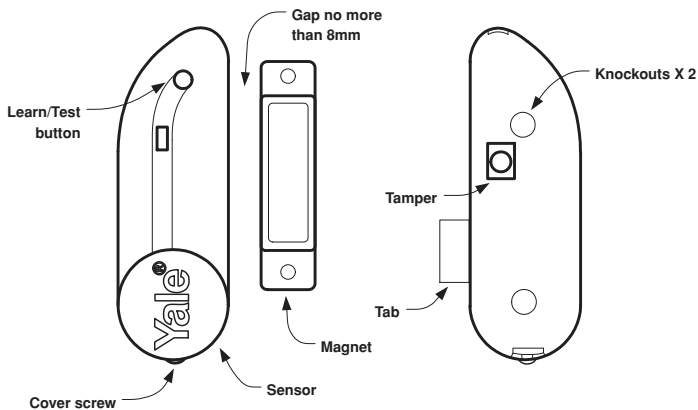

Pack contents

- 1 x HSA6010 Door/window contact.
- 2 x wall plugs.
- 1x 2.6 mm (diameter) x 10 mm cross head fixing screws.
- 2 x Adhesive pads for Door/Window contact fitting.

Door/Window contact description

Status LED: Red LED indicates door contact state.

Learn/Test button: Used for testing the radio performance and for learning-in.

Cover screw: Provides access to inside of door contact.

Tamper Switch: Spring loaded switch to protect the door/window contact from being removed.

Tab: Pull out battery saver tab to activate battery.

Magnet: Actuates sensor.

Knockouts: Punch through panels to provide holes for screw fixing.

Specification

Conforms to:

EN 300 220-1 / V2.1.1 (2006-04)
 EN 301 489 -1, / V1.6.1 (2004-12)
 EN 301 489-3, / V 1.4.1 (2002-08)

Environmental conditions:

-10°C to 40°C, relative humidity 70% non-condensing

Radio: Microcontroller controlled
 433.92MHz AM transmitter.

Battery: 1X 3V CR2032 Lithium Coin Cell,
 2 Years life at 50 activations per day.

Programming & testing

Program your door/window contact before installation and test afterwards. Please see your current system instruction book.

Location

Locate the door/window contact accessory taking into account the following points:

- Mount as high as possible
- Do not aim a PIR at this door or window

Installation

Screw mounting

- 1 Break through the knockouts (where the plastic is thinner).
- 2 Using the holes as a template, drill holes in the surface and insert wall plugs if fixing



NoPb CE



into plaster or brick. Screw the rear case to the wall using the knockouts.

Self adhesive installation

Clean the surface with a suitable degreaser.

- 1 Remove the protective covering from one side of the double sided adhesive pad and firmly apply to the back of the device.
- 2 Remove the other cover and firmly press the item onto the desired location.

Do not use the adhesive pad method of installation on a surface with peeling or cracked paint, or on a rough surface.

- 3 Mount the detector base on the frame and align the magnet.

- The magnet should not be more than 8mm from the detector when the door is closed.
 - Ensure the tamper switch spring is positioned so that it makes contact with the mounting surface through the tamper switch aperture.
 - When fitting to a window, fix the magnet to the moving part and the detector to the frame.
- 4 Fix the detector on its base and secure with screw.

Yale[®]

Yale UK

School Street, Willenhall
 West Midlands WV13 3PW
 Tel +44 (0)1902 364647
 Fax +44 (0)1902 364692
 E-mail info@yale.co.uk
www.yale.co.uk

E1 12/06

ASSA ABLOY